

Basement Finish Information Sheet

Existing home foundations, built prior to June 2009 are exempt from the *MN Energy Code* regulations. Applicant may choose the insulation type if any, and simply follow the manufacturer's installation instructions. *(Exposed foam on walls must be covered or approved type.)*

Construct all walls on **treated or redwood plates**. Hem-fir, Doug-fir or S-P-F plates not allowed.

Electrical outlets required every 12' along walls and 6' from door openings.

Dedicated GFI circuit required in bathroom.

Carbon monoxide alarm

Smoke detectors: Electronically-operated detectors in new basement finish and all bedrooms. Install battery-operated detectors in existing bedrooms and floors not equipped with smoke detectors.

Minimum **ceiling height** is 7' with 6'-4" allowed for projections such as beams and ducts.

Gas-fired furnace or water heater cannot be in a bedroom, bathroom or closet.

Creation of a full kitchen in the basement of a single family home must be reviewed for conformance with zoning regulations.

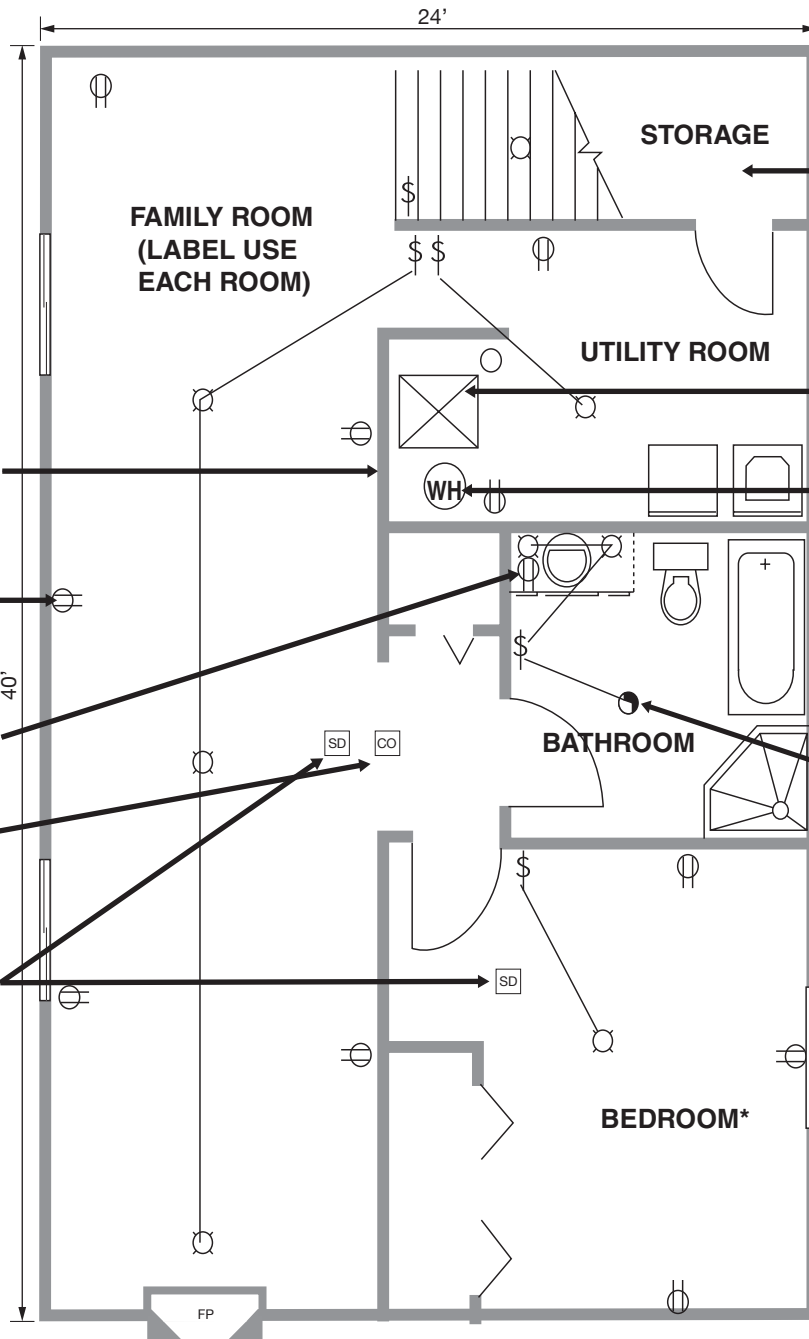

Protect storage under stairs on enclosed side with 1/2" gypsum board.

Provide combustion air to furnace and clear 30" working space in front of furnace.

A **water heater** must be able to be removed with the furnace intact.

Supply and return air is required for all habitable rooms.

A **bathroom fan** is required unless there is an operable window. Insulate the fan duct a minimum of 3' from the outside of the house rim.

Show **window sizes**. Egress window required in each bedroom. Egress size: 5.7 sq. ft. of operable area with 20" min. width and min. height of 24". Sill no more than 44" above floor.

*** There are varying clearances to combustible materials when building next to new or existing fireplaces. Discuss with Plans Examiner when obtaining permits.**

See city handout for arc fault circuit interrupters.

*** Arc-fault circuit breakers (AFCB) to be installed per current NEC.**

Note: Electrical panels are NOT allowed in bathrooms or clothes closets.

This information is a guide to the most common questions. It is not intended, nor shall it be considered, a complete set of requirements.